



## OctaPack

Bulk goods are now stackable!

Announcing the next generation of bulk containers – OctaPack, the plastic octagonal bin with an integrated twin-sheet pallet and a specially designed lid! This innovative container permits problem-free stacking and can be used outdoors in any weather.



## The Plastic Bulk Transport Container

OctaPack takes bulk packaging to the next level, setting new industry standards and winning over enthusiastic users every day. Combining the tried-and-tested advantages of TRIPLEX structured-core walls, specially designed lids and an integrated twin-sheet pallet base with an optional base outlet port, OctaPack provides users big advantages. Special design features – such as the octagonal cross-section, sturdy injection-moulded pallet feet and receiving recesses in the lid which mate to the feet of the container above – provide almost unlimited stackability even when loaded. As a result, storage floor space requirements are reduced by 50 % or more. OctaPack is ideal for outdoor use as it securely protects its contents from inclement weather. Even when used indoors and outdoors under tough conditions, OctaPack provides reliable service for over 100 cycles and more. Due to its collapsible "M"-design and perfectly nesting base pallets and lids, OctaPack is easy to store and transport when empty with minimum space requirements.

Two types of lids are available for the OctaPack system. A lightweight single-sheet lid made of high-impact polycarbonate is used in applications in which ease of handling and low cost are desired. A heavier, sturdier lid made of high-impact HDPE is preferred for applications requiring higher stacking stability.

For more information on TRIPLEX® structured-core technologies, visit our website at [www.triplex-gmbh.de](http://www.triplex-gmbh.de)



## Advantages and Benefits

- significant cost savings due to reusability
- extremely durable, even outdoors
- long service life, many use cycles
- outstanding strength
- rugged, not easily damaged
- protects contents ideally from inclement weather
- multiple stackability
- substantially reduced storage area requirements
- sloped base and outlet ensure complete emptying
- volume-saving storage when empty with nestable components
- no material accumulation in corners
- sturdy twin-sheet base pallet
- various lid designs available
- extremely sturdy pallet feet, can be replaced individually

## Available Features

- pallet with integrated floor insert (PE REC, black)
- collapsible container body made of structured-core panels (PP grey or PP REC black)
- lid (single sheet: PC REC black or twin sheet: HDPE REC black)
- outer base perimeter 1.20 m x 1.20 m
- recommended system heights: 1.15 m or 2.30 m
- container body available in custom colours
- numerous options including document pouches, custom printing, etc.

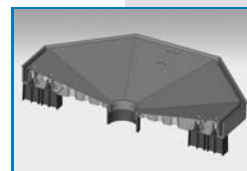

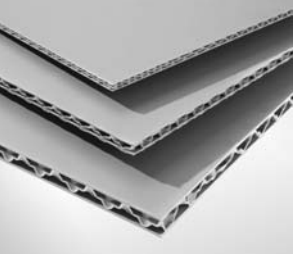

## Our Promise

At TRIPLEX, we focus on coming up with new, surprising ideas – today we're thinking about your requirements for tomorrow. In looking for new ways to solve your problems, we are not afraid to take unconventional paths, relying on imagination for uncommon solutions along with courage to travel uncommon routes. By keeping our eyes open and constantly learning more, we break through barriers and set new standards. True to our roots as a family-owned company, we listen exactly to what you have to say and attach utmost importance to fairness in our business relationships. At TRIPLEX, our employees, customers and suppliers are fully committed with their hearts and their minds and work together as partners.

DIN EN ISO 9001:2000

Certified



### **TRIPLEX® Kunststoffe GmbH**

Heinrich-Schickhardt-Straße 1

72221 Haiterbach (Germany)

Telephone: +49 - (0) 74 56 - 93 99-0

Telefax: +49 - (0) 74 56 - 93 99-13

info@triplex-gmbh.de

www.triplex-gmbh.de